

! This cautionary note is excerpted from the section that requires special attention.
Read the installation manual carefully for details, and install the product correctly according to the instructions.

<Water supply hose (F-2, F-3) >

Push the water supply hose for the Washlet to the rear of the water supply hose for the toilet bowl.

* Failure to fit the water supply hose (F-3) for the Washlet may result in A-2 coming off.

<For water supply from the floor>

Push while pulling F-2 towards you.

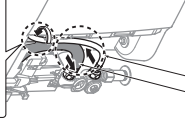

Washlet water supply hose (white) (F-3)

Toilet bowl water supply hose (black) (F-2)

* See page 11 of the installation manual.

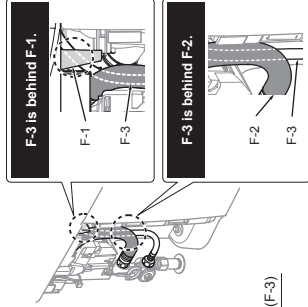

<C-9>

Install C-9 before attaching the toilet to the drainage socket.

If you do not, it will be impossible to flush the toilet bowl during a power outage.

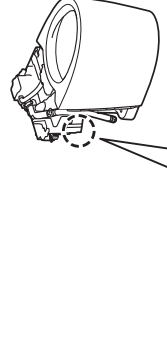

● Pass the strap through the slit in the base.

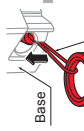

● Pull on C-9 and secure the hook in place.

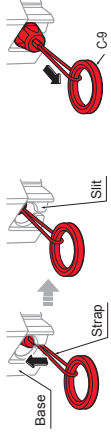

● This flushing ring is used in the event of a power outage. Do not use (pull) it during installation. Doing so may cause water to continue to flow into the toilet bowl during test operation.

Manual water supply cord



Do not use (pull).

By pulling the manual water supply cord (orange) until it stops, you can toggle the flow of water to the toilet bowl on and off.

* See page 8 of the installation manual.

See reverse side for installation manual.

*The product may be slightly different in shape than the product shown in the figure depending on the model.

TOTO

TOILET BOWL UNIT



H0B515
2024.2
(This code is for manufacturer management use.)

Installation manual

Safety Cautions P.2

Precaution before installation P.3

Included parts P.4









Part diagram P.5

Installation procedure P.6

For installers P.12

Safety Cautions (Observe these cautions for safety's sake.)

Read these "Safety Cautions" carefully before starting installation work. Install the product properly. This manual uses various indications to ensure a proper, safe installation and to prevent injury to the customer, injury to other people and damage to property. The symbols should be interpreted as follows.

 Caution		Improper use or installation of this product may result in injury or property damage.	
	 This symbol is used to indicate no tampering with this product.		 This symbol is used to indicate a required step in the use of this product.
 Caution			
 Prohibited	Do not subject the toilet bowl to strong forces or impacts. Otherwise, the toilet bowl may break causing injury or leaks that may damage property.		
	Do not excessively bend or twist the water supply hose. Otherwise, the flexible water supply hose may break causing leaks that may damage property.		
	Do not remove the water supply filter with the water supply valve being open. If the water supply valve is not closed, water may gush out causing leaks that may damage property.		
 Required	Be sure to use the included or specified parts for installation work. Otherwise, the product may not be installed properly.		
	Carry out the installation work according to this installation manual. Otherwise, damage caused by water leaks may occur.		

Precaution before installation

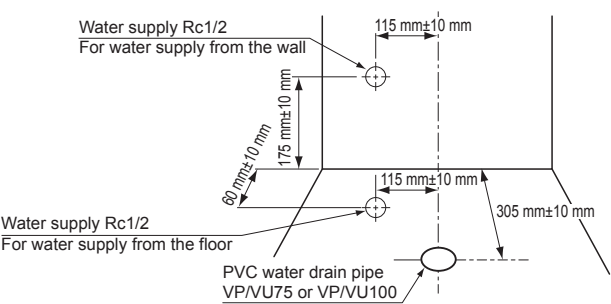

- Exercise care to ensure that metal objects (wristwatch bands, belt buckles, A-2 magnets, etc.) do not come into contact with the ceramic during installation, transport, or cleaning. Such objects could rub the surface of the ceramic and leave stripe marks.
- Secure the space required for toilet installation and at the same time, check door opening/closing for possible interference.
- The remote control signal reception may be degraded and the NEOREST unit may not respond to the remote control if there are shelves or cabinets on the rear wall at a height of less than 1400 mm from the floor. (Shelves and storage cabinets should be more than 1400 mm from the floor.)
- Make sure before installation that the water supply source and water drain pipe are in the specified positions according to the diagram. If it is not positioned properly, the product may not be able to be installed correctly.
- For water supply, ensure that the minimum required water pressure (flowing) is 0.05 MPa at 10 L/min. (while maximum water pressure is 0.75 MPa)
The product automatically measures water pressure conditions in the operating environment during toilet bowl cleaning and adjusts the volume of toilet bowl flush water used.
- Turn on electricity and water supply to the product after completing all installation work.

• This flushing ring is used in the event of a power outage. Do not use (pull) it during installation. Doing so may cause water to continue to flow into the toilet bowl during test operation.

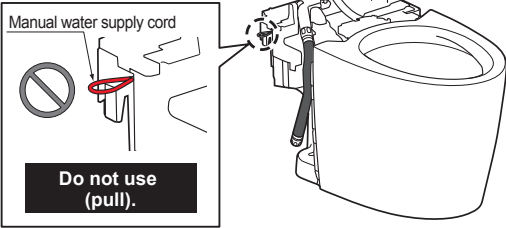

Manual water supply cord

Do not use (pull).

By pulling the manual water supply cord (orange) until it stops, you can toggle the flow of water to the toilet bowl on and off.

• Before installing the product, be sure to completely wash out any dirt, sand, etc. from inside the water supply pipe.

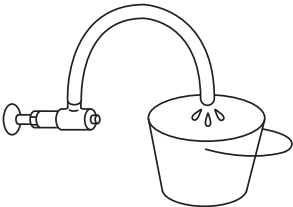

Included parts



A-1



A-2



A-3



B-1



B-2

Caution Be sure to mount B-2.
Dirt contamination could cause shutoff or discharge defects.



B-3



B-4



B-5

B-4 are not necessary for water supply from the wall.



C-1



C-2

*Be sure to mount C-2.



C-3



C-4



C-5



C-6



C-7



C-8

When using the floor flange, C-2 (2 pcs.), C-7 (2 pcs.) and C-8 (2 pcs.) are not used.

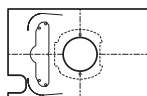

D-1



D-2



D-3

*D-3 is affixed on the backside of A-2.

*The product may be slightly different in shape than the product shown in the figure depending on the model.

Part diagram

For water supply from the wall

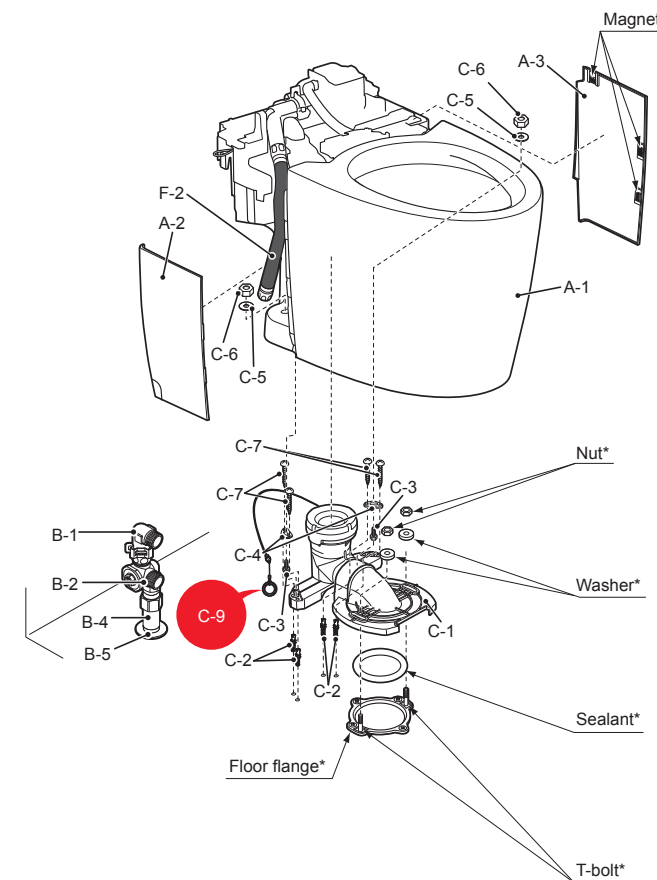
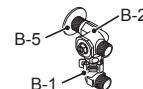

This manual uses illustrations of a floor water supply for explanatory purposes.

*The floor flange, Nut, Washer, T-bolt and sealant are not included.

Installation procedure

1

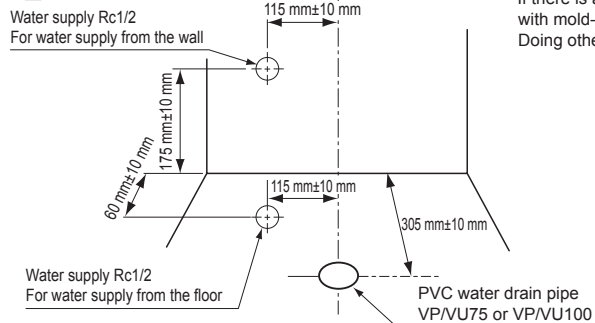

2

Caution Be sure to install the shutoff valve (with filter) (B-2) included with the toilet.
Dirt contamination could cause shutoff or discharge defects.

- ① Install B-1 to B-5.
• Apply sealing tape to the screw threads and install.
- ② Orient B-1 and B-2 properly.
• If the fixture is not oriented properly, A-2 may not be attached or may come off.

For water supply from the floor

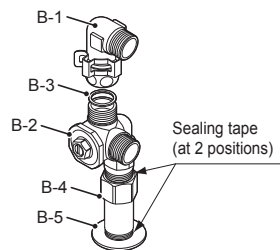

Orient so that the connection port faces straight to the front.

Orient so that the hexagonal part faces to the side.

<View from above>

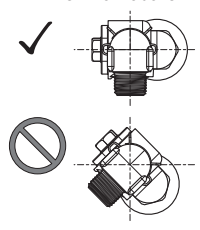

For water supply from the wall

B-4 are not necessary for water supply from the wall.

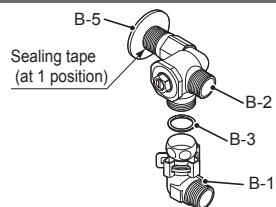

Orient so that the hexagonal part faces to the side.

Orient so that the connection port faces straight to the front.

<View from front>

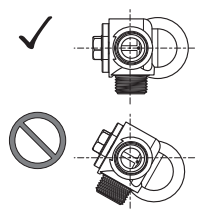

Caution <For water supply from the floor>

If there is a gap between the straight pipe and the floor, fill it with mold-resistant silicone-based seal material (Mediseal), and then attach a cover seal(B-5). Doing otherwise may cause water to leak downstairs.

3

For water supply from the wall



4

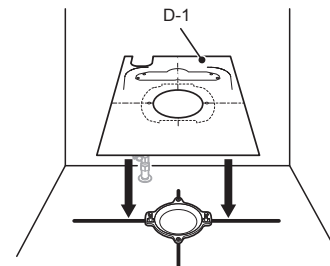

5

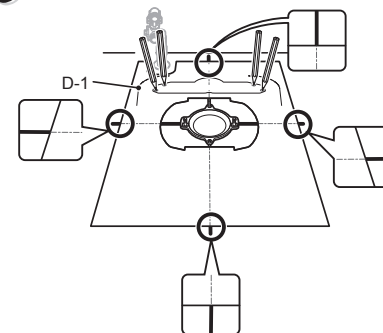

6

D-1

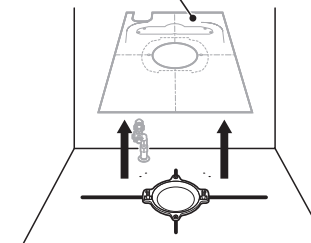

7

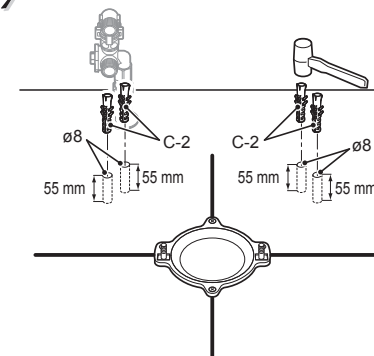

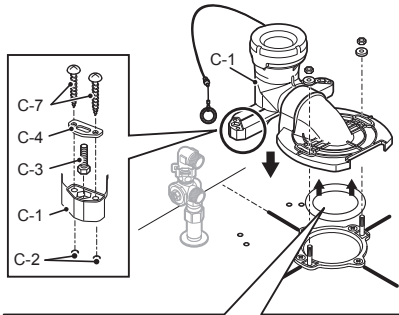

Set so that the sealant does not enter the drainage channel area (in the hatched area). Doing otherwise may cause inadequate flushing.

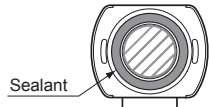

Rear surface of floor flange connection area
*The figure is for a metal flange

- Securely fit the head of C-3 into the hexagonal hole of C-1. If it is not inserted completely, the toilet bowl may be unstable.
- When installing, be careful that the wire does not get pinched between the floor and discharge socket.

⚠ Caution

Caution in handling of the Sealant

(For plastic flange)

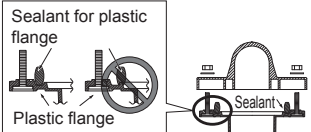

(For metal flange)

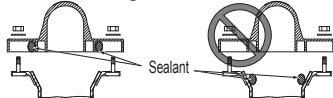

Required

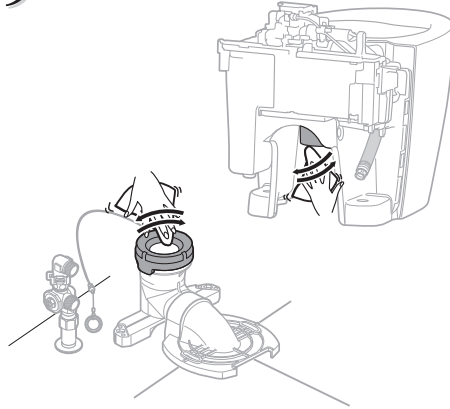

Be sure to install C-9.
If you do not, it will be impossible to flush the toilet bowl during a power outage.

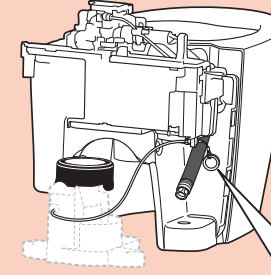

① Pass the strap through the slit in the base.

② Pull on C-9 and secure the hook in place.

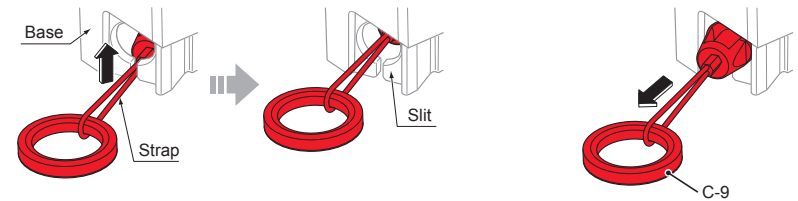

Review and check the following:

- ☐ After installation, did you verify that C-9 will not come off the base?

- This flushing ring is used in the event of a power outage. Do not use (pull) it during installation. Doing so may cause water to continue to flow into the toilet bowl during test operation.

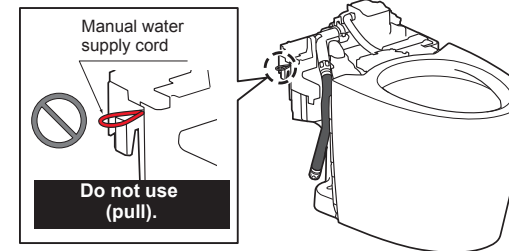

By pulling the manual water supply cord (orange) until it stops, you can toggle the flow of water to the toilet bowl on and off.

< Removing the manual water storage cord (white) >

Grasp the hook with your fingers and push to remove it from the base.

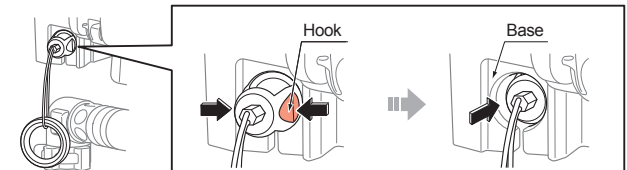

11

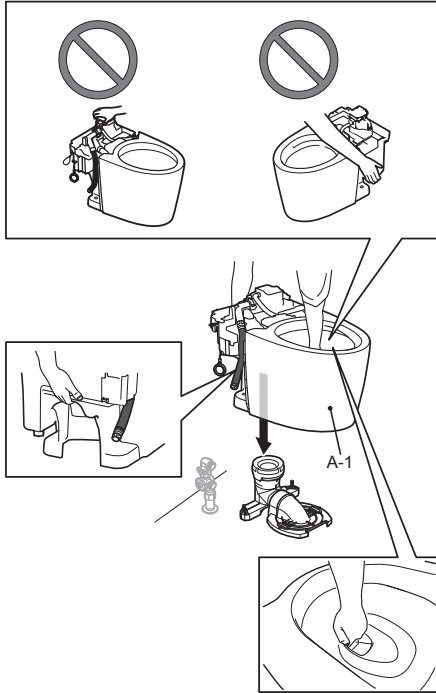

Proper routing of C-9

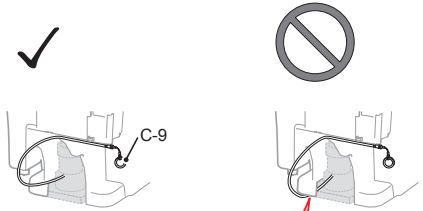

Do not allow the C-9 strap to become caught.

*Do not pull the C-9 strap or cause it to be pinched by the toilet bowl.

12

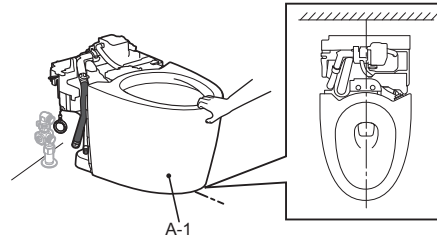

13

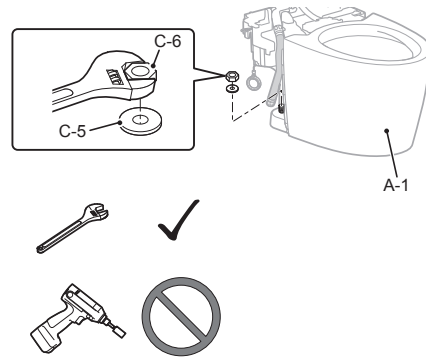

14

Install the top unit according to Installation Manual included with the top unit.

15

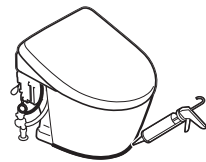

16

- ① Verify that the washlet water supply hose (white) (F-3) is positioned behind the toilet bowl water supply hose (black) (F-2).

〈For water supply from the floor〉

If F-3 is positioned in front of F-2, push F-3 behind F-2 and push F-2 towards the toilet bowl.

Push while pulling F-2 towards you.

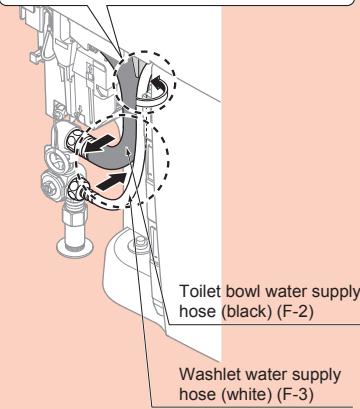

Verify that the hoses are not touching A-2.
*Contact with the hoses could cause A-2 to become detached.

F-3 is behind F-1.

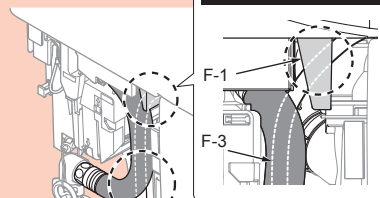

F-3 is behind F-2.

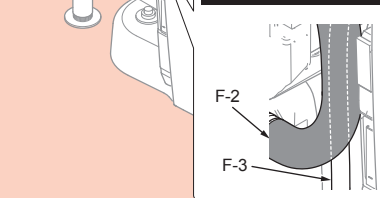

- ② Install aligned with the toilet bowl upper surface and toilet bowl side surface, so that there are no noticeable gaps with the toilet bowl.

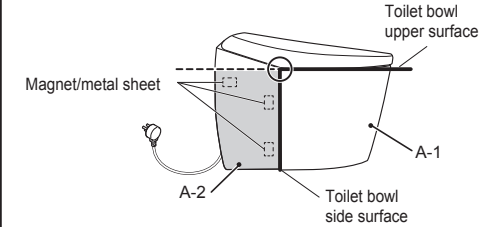

- Press down firmly on the three magnets and verify that A-2 does not become detached.
- If A-2 exhibits any gap or float, refer to 16-① and verify the position of the water supply hose.
- If there is any gap or float, A-2 or the metal sheet could become detached from A-1, preventing installation.

- After the trial-run (flush) of the toilet bowl, check the toilet bowl inside for foreign matter such as chips of cut pipe, etc. Foreign matters such as transmitted rust can stick to the sides.
- Make sure that there are no scratches or other damage on the ceramic surface. If the ceramic surface is tightly pressed or rubbed against metals (watchbands, belt buckles, etc.), black or silver streak marks may be left on the surface.
- After installation, unseen dirt (oil or adhesive for piping) may remain in the toilet bowl. Be sure to wipe it off using a non-abrasive neutral detergent for toilets. Otherwise, the toilet bowl surface may not flush completely clean.
- Confirm that there is no noticeable gap between the porcelain and side panel and that neither part is lifted up. If the parts are not installed firmly, the side panel could detach.
- After conducting a test run, confirm that no connections are leaking water. Not installing the properly may cause water leaks that could result in flooding damage to property, such as household belongings.
- After test operation, make sure to clean the water filter with the shutoff valve closed.
- * Remove the water filter using D-3 or a tool such as a ratchet wrench, and clean the filter.
- * Make sure to open the shutoff valve after cleaning the filter.

