

WALL HUNG BASIN INSTALLATION INSTRUCTIONS

- Observe all local plumbing and building codes.
- Prior to installation, unpack the new basin and inspect it for damage. Return the basin to its protective carton until you are ready to install it.
- Due to the variety of installations possible with this basin, you may need to use procedures other than those described.
- It is very important that proper high-quality materials and silicones are used with your basin.

- 1** Hold your basin against your wall in the desired location and mark out the fixing holes on the wall.

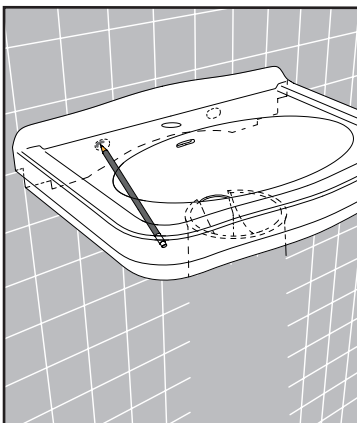

- 2** Drill holes in wall for fixings.

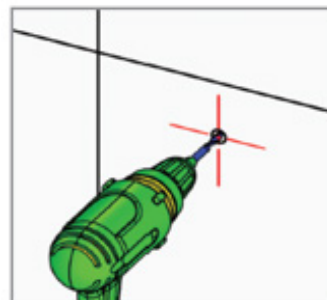
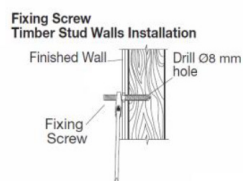
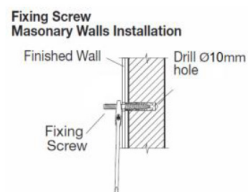

- 3** Install fixings and hang basin on wall using level.

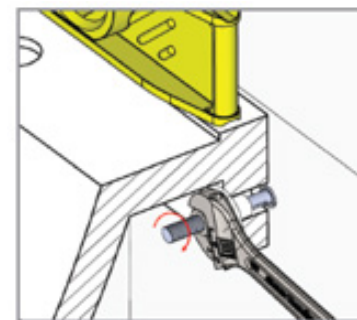
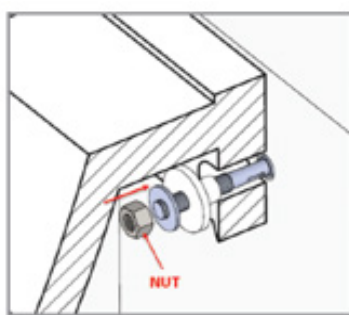
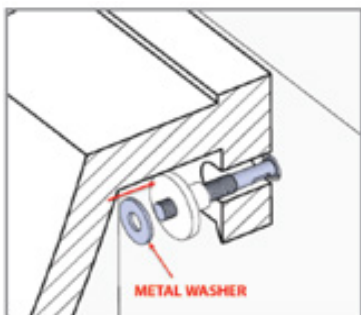
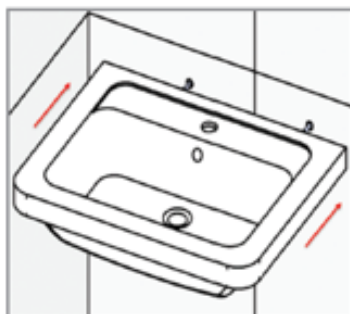
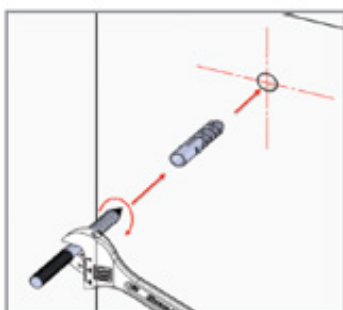

- 4** Silicone basin along top edge and side if desired and attach tap, waste and trap.

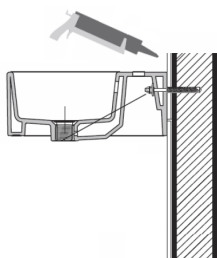

BASIN WITH PEDESTAL INSTALLATION INSTRUCTIONS

- Observe all local plumbing and building codes.
- Prior to installation, unpack the new basin and pedestal and inspect it for damage. Return the basin and pedestal to its protective carton until you are ready to install it.
- Due to the variety of installations possible with this basin and pedestal, you may need to use procedures other than those described.
- It is very important that proper high-quality materials and silicones are used with your basin.

1 Place basin on top of pedestal in the desired location and mark out the fixing holes on the wall.

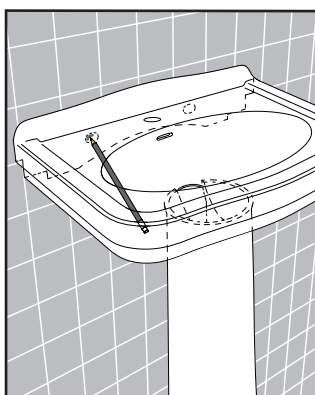

2 Drill holes in wall for fixings.

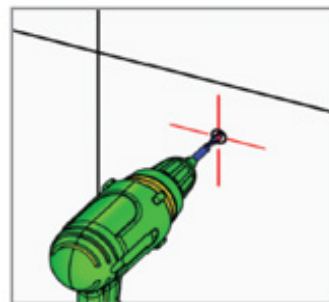
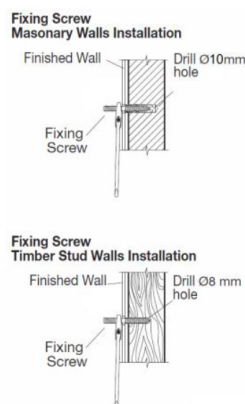

3 Install fixings into wall, slide basin and pedestal together onto bolts and tighten nuts while using level.

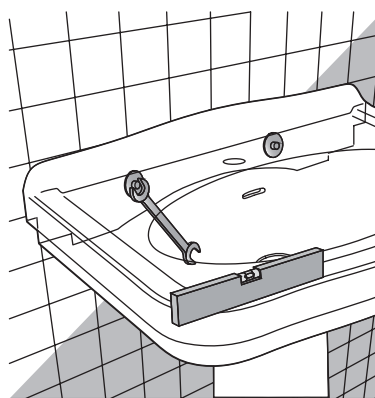
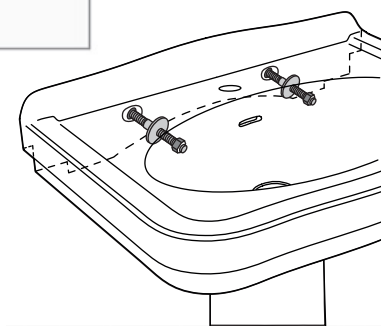
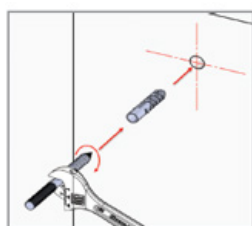

4 Silicone pedestal to floor, and basin along top edge and side if desired and attach tap, waste and trap.

