

K-35OP

OPEN HOUSE CERAMIC MIXING CARTRIDGE
35 MM SIZE



MADE in the EUROPEAN UNION

- You can set the temperature by rotating the lever.
- Opening action provides flow rate control.
- The mixed water runs out from the output on the side of the cartridge.
- This model has two features which save energy:
ECO function saves water consumption and there is a HWS ring which allows you to set the maximum usable temperature of the hot water.

TECHNICAL CHARACTERISTICS OF THE CERAMIC DISCS:

Material:	Al ₂ O ₃
Surface roughness Ra:	0.3 µm
Contact surface area:	50-80%

TECHNICAL CHARACTERISTICS OF THE CARTRIDGE:

Opening angle:	25°
Mixing angle:	90°
Max. water pressure:	35 bar / 500 psi
Max. temperature:	90°C/194°F
Recommended tightening:	12-13 Nm / 106-115 lbf•in
Pressure test:	
pneumatic:	6 bar / 87 psi
hydraulic:	35 bar / 500 psi
Flow rate:	(3 bar / 45 psi, test faucet, EN 817) 26.6 l/min / 7 gpm without resistance 19.4 l/min / 5.1 gpm with resistance „C“
Endurance test:	EN 817 70 000 cycles ASME A 112.18.1M 500 000 cycles

K-350P

OPEN HOUSE CERAMIC MIXING CARTRIDGE
35 MM SIZE

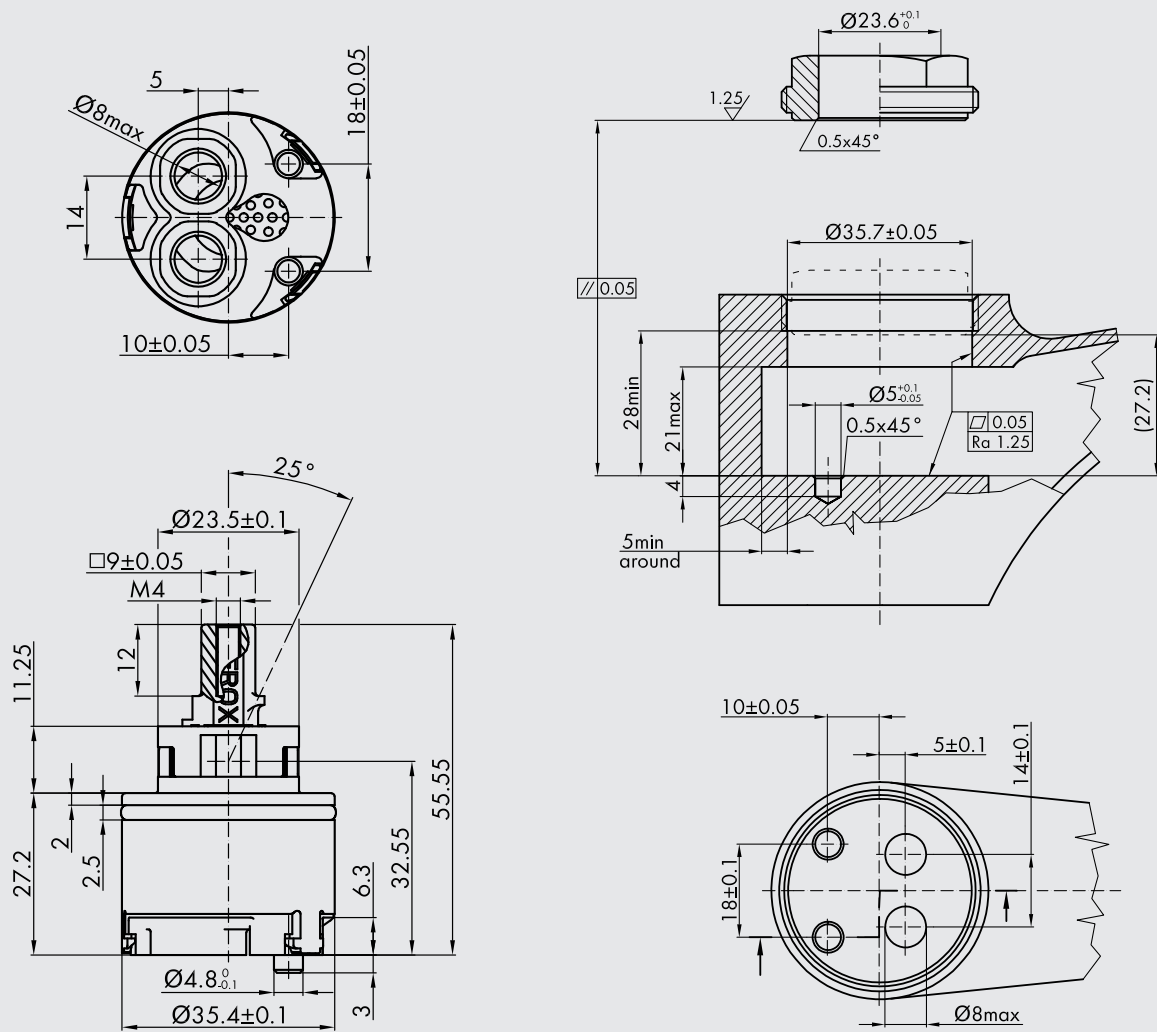

CARTRIDGE

BODY



FLOW RATE CURVE

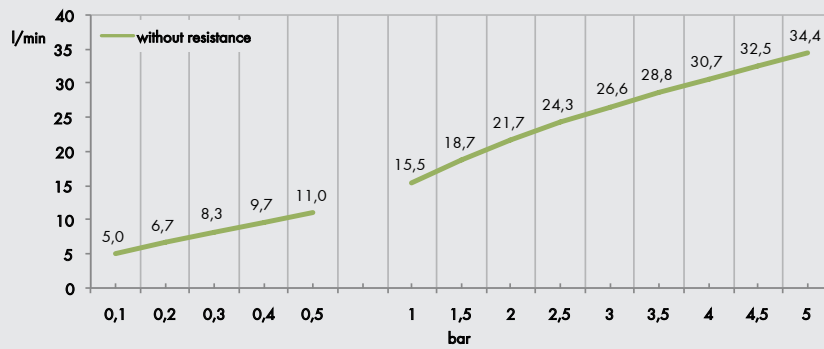

FLOW RATE & HYSTERESIS CURVES

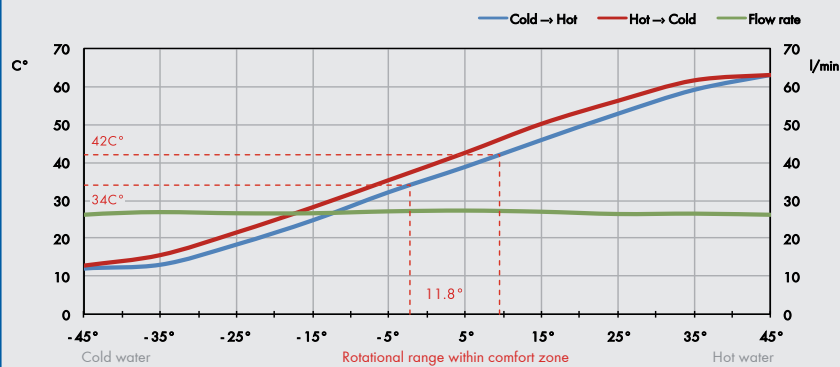

General requirements for nut and faucet:

1. Made of solid metal material instead of plastic
2. Usage of any lubricant on threads is not allowed
3. No sharp or burry sections at sealing surfaces
4. Recommended tightening torque is relevant to brass-brass connection with 1.5 mm thread pitch.

