

CARTRIDGE REPLACEMENT INSTRUCTIONS

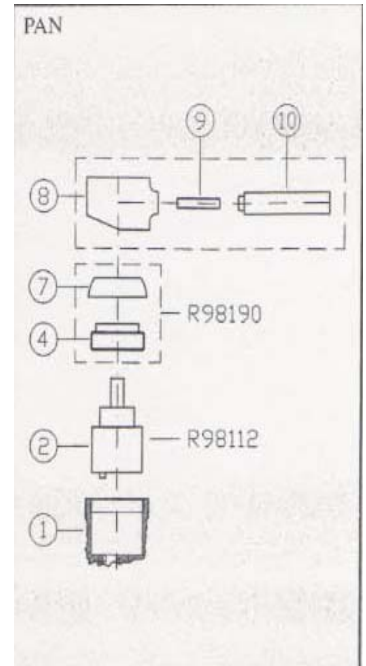
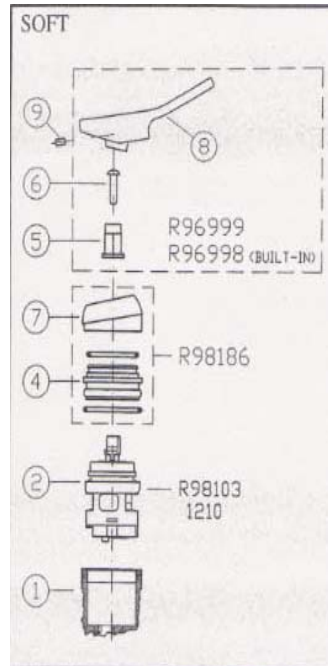
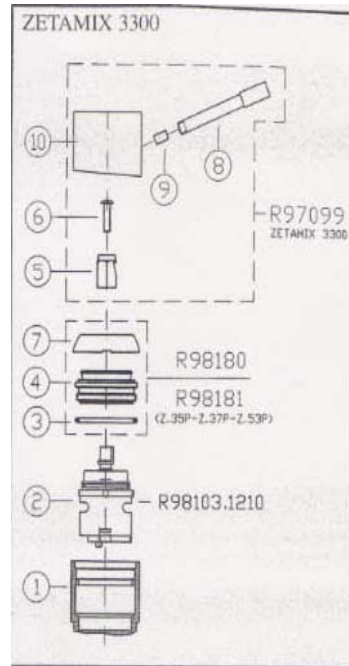
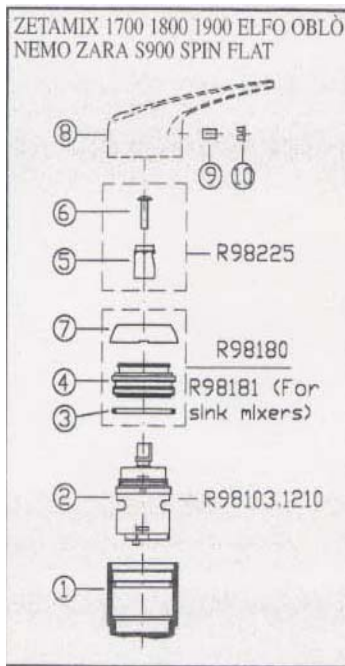

CARTRIDGE REMOVAL

Turn off water at meter, then turn on garden tap to release pressure. Turn on mixer to ensure water flow has stopped.

Zetamix 1700, 1800, 1900, s900, Elfo, Oblo, Nemo, Spin, Flat, Zara

Remove red/blue button (10) positioned on front of handle

Remove grub screw (9) with 3mm allen key & pull off handle (8)

Undo screw (6) and pull off hexagon adaptor piece (5)

Lever off the plastic locknut (4) dome (7) using the notch for that purpose.

Zetamix 3300

Unscrew the handle (8) and the screw underneath (9) anticlockwise (with a 3mm allen key).

Remove the cap (10) then remove the lock nut cover ring (7) by levering inside the proper notch.

Unscrew the screw (6) and remove the plastic adaptor (5).

Remove lock nut (4) using a 36mm spanner and remove the old cartridge (2).

Soft

Remove the handle (8) that is fixed in place with dowel (9) (using a 2.5mm allen key).

Unscrew the screw (6) and remove the adapter (5).

Remove the ring nut cover (7), Fixed in position by the relative o-ring.

Using a 26mm spanner, unscrew the fastening ring nut (4)

Next, remove the cartridge (2)

Pan

Unscrew (by hand) the handle (10)

Using a 3mm allen key unscrew the dowel (9).

Remove the cap (8)

Unscrew (by hand) the ring nut cover (7).

Using a 30mm spanner, unscrew the ring nut (4) and remove the cartridge (2).

CARTRIDGE REPLACEMENT

Ensure that the rubber seals at the bottom of the cartridge (2) are seated correctly.

Ensure inside of tap body (1) is clean.

Line up the two lugs on the bottom of the cartridge with the two according holes on the inside bottom of the tap body and insert the cartridge.

Screw locking cap (4) back on, nip it tight (nip it with a tightening torque of 10Nm only PAN products). Refit remaining parts in reverse sequence of removal instructions.

REMOVING DIFFICULT HANDLES.



1. Locate the red/blue indicator cap on the handle & remove it. This will reveal the grub screw holding the handle.



2. Using a 3mm allen key, remove the grub screw.



3. Using a small flat head screw driver, unclip the plastic chrome dome cap sitting under the handle. There is a small slot to insert the screw driver into to release it.



4. Using the same screw driver, hold it under the back of the handle and underneath the dome cap as illustrated above. Now using an upward motion as if you were turning the tap on, the handle should come off. It may require a bit of effort so don't be afraid to do so.