

SERENA SMART BIDET SEAT

EC105 & EC110

INSTALLATION INSTRUCTIONS & USER MANUAL

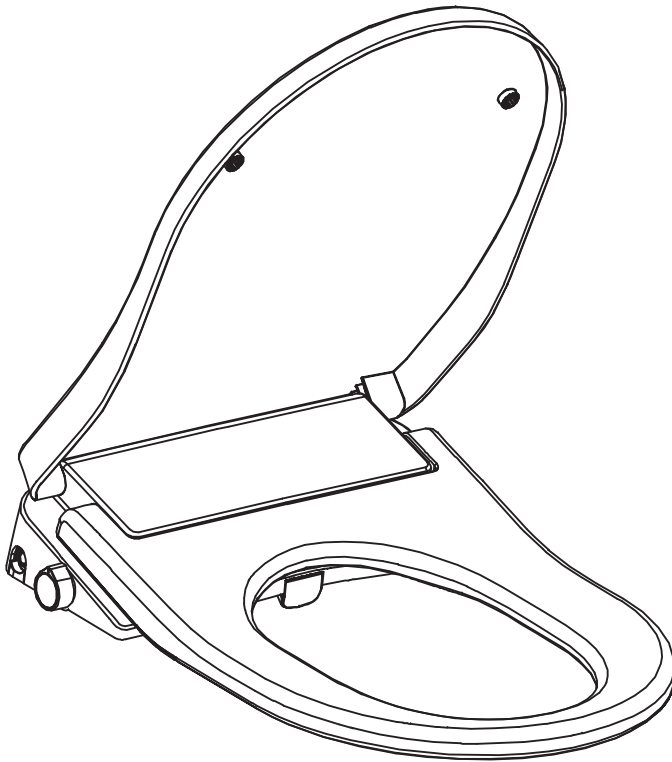

Thank you for purchasing our product.

Please follow the instructions in this manual carefully.

Please keep the manual properly stored for future reference.

Regarding future product updates, the product is subject to change without prior notice.

Illustrations in this manual serve as visual demonstration.

In order to guarantee that the product will always function optimally, and to ensure your personal safety, please read and follow these installation instructions carefully before starting.

CONTENTS

Safety Notice 1

Product Description 3

Components 4

Installation 5

Operation 9

Cleaning and Maintenance 11

Troubleshooting 13

Dimensional Drawings..... 14

Technical Specification 15

SAFETY NOTICE

Installation must be carried out by qualified professionals. Plumber and Electrician

Before installation, please read the following safety instructions carefully. Installation should be based on the steps documented in this manual. We will not take responsibility for damages or faults that may be caused by changing the assembly method without authorization.

PARISI will not be liable for any loss arising from failure to comply with the following:

- This device is an electric appliance of class “1” and must be connected to a grounding system.
- The power circuit connected to the product must have a residual current protective device (RCD) with a rated residual operating current that does not exceed 30mA, and an effective grounding loop.
- If the installation is not using the supplied cable and plug, we recommend the bidet seat is wired via an isolating switch in the bathroom.
- The socket should come with waterproof function or waterproof accessories to ensure safety. The sockets and plug should not be installed in a location where it can come in contact with splashing water. e.g. bath or shower. Check with your electrician re wet area zones.
- If the power supply cord becomes damaged, do not use the device until it has been repaired by a qualified electrician.
- Do not insert or remove the power plug with wet hands.
- Children and persons with insufficient knowledge or experience in handling the device, or who have limited physical, sensory or mental capabilities, may only use the device following proper instruction or when supervised.
- **WARNING:** THIS TOILET DOUCHE MUST BE INSTALLED WITH APPROPRIATE BACK FLOW PROTECTION CONFORMING TO THE NATIONAL CONSTRUCTION CODE – VOLUME 3. INSTALLATION MUST BE IN ACCORDANCE WITH AS/NZS 3500.2 AND PLUMBING CODE OF AUSTRALIA.
- THIS TOILET DOUCHE SEAT IS FITTED WITH AN INTEGRAL HIGH HAZARD PROTECTION DEVICE (AVB) THAT COMPLIES WITH THE TEST REQUIREMENTS OF AS 2845.1:2022
NOTE: LOCAL AUTHORITIES MAY HAVE VARYING REQUIREMENTS. CHECK TO CONFIRM IF A RPZ VALVE IS REQUIRED

SAFETY NOTICE

To reduce the risk of malfunction or damage to product

- Only connect this bidet seat to a domestic potable water supply. Do not use industrial, recirculating water or waste water to the appliance.
- Before final installation ensure that all water hoses and lines are thoroughly flushed to remove any debris.
- Water pressure must not exceed 500Kpa.
- The power voltage is 220-240V~ 50/60Hz. Use the specified power supply only.
- Water Temperature Range: 4-35°C. Do not install the intelligent toilet in rooms where the temperature will be less than 4°C (39°F).
- Do not bend, squeeze, or warp the water supply hose or power cable excessively.
- Do not place the product upside down.
- Stepping on, sitting on the bidet seat lid will cause damage to the lid and mechanism.
- The installed bidet seat must use the supplied or specified components. Do not reuse the old hose assembly, otherwise the product may be damaged.
- Do not remove the protective film on the product surface during installation to reduce surface scratches.
- After the installation is complete, connect water supply first and then connect the power supply.
- Direct sunlight may cause discoloration in the seat or destabilise the seat temperature.



NOTICE

- The product has been water tested before leaving the factory. A small amount of residual water may flow out when the product is taken out, which is normal.

PRODUCT DESCRIPTION

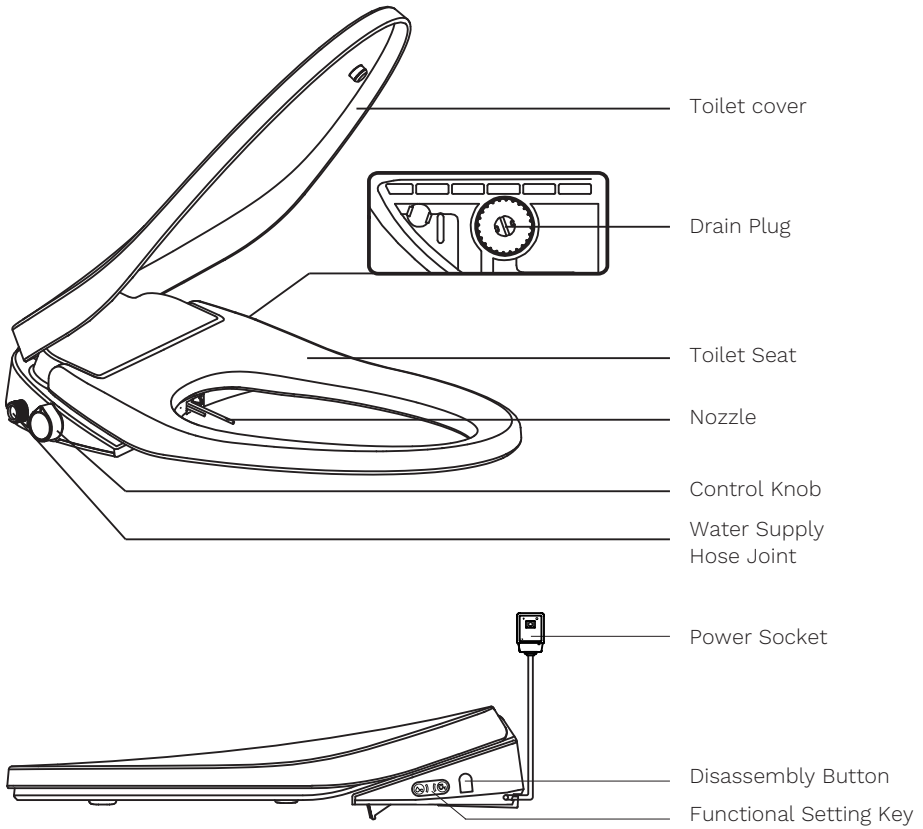

Functional Setting Key

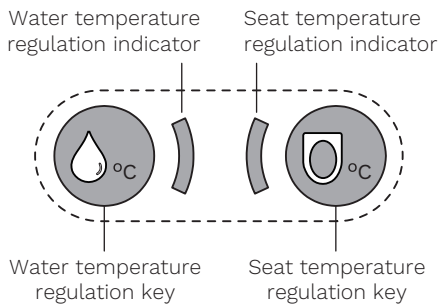

Control Knob

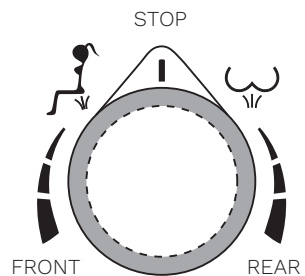

COMPONENTS

NOTE: THERE ARE TWO INSTALLATION METHODS FOR THIS PRODUCT.
PLEASE CHOOSE ONE METHOD ACCORDING TO YOUR INSTALLATION REQUIREMENT.

1. Electronic Bidet Seat

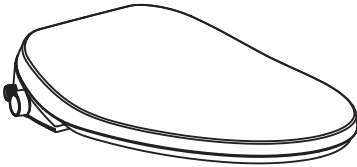

2. Installation Template

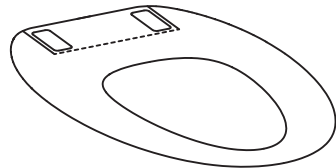

3. Fixing Kit



Screws (x2)



Adjustment sheet (x2)

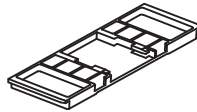

Fixing plate (x1)



Expansion bolt (x2)
(Up Lock)



Nut (x2)
(Down Lock)

4. T-Junction

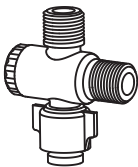

(Side Inlet Only)

5. Water Inlet Hose

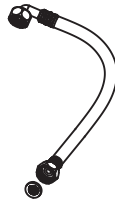

Filter screen

6. User Manual

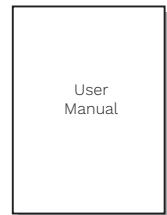

PREPARATIONS

Installation Tools

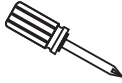

Screwdriver



Wrench



Bucket and Soft Cloth

Installation Precautions

1. Recommended water pressure range: 150-500kPa, please follow the instructions.
2. Angle valves must be located close to the location where this product is installed and disassembled.

PROCEDURE FOR SIDE INLET INSTALLATION



1. IF you have an existing toilet seat installed, you will need to remove the old seat and uninstall the existing hinge set completely before you can proceed with the installation of the bidet seat. Make sure you clean the surface of the pan and dry the pan with a soft cloth before proceeding with step 2.

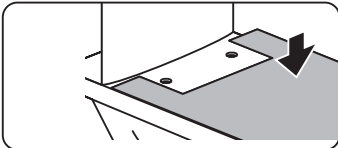

2. Place the installation template on the ceramic as shown. Align the template with the front of the toilet rim.

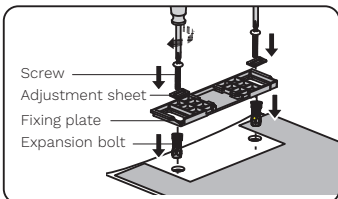

- 3A. Install fixing plate (up locking)
 - 1) Place the stainless steel adjusting sheet in the mounting groove, align the expansion bolt hole and tighten screw with screw driver.
 - 2) Insert the expansion bolt into the ceramic hole, and place the fixing plate in the notch part of installation template.

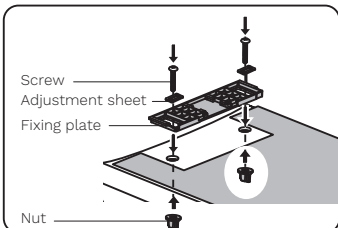

- 3B. Install fixing plate (down locking)
 - 1) Place the fixing plate in the notch part of mounting template.
 - 2) Place the stainless steel adjusting sheet in the mounting groove, align the circular hole on the ceramic and place in the screw, and lock the plastic nut and screw from the inside of the ceramic.

Note: You can choose installation mode 3A or 3B depending on the installation requirement.

INSTALLATION Cont.

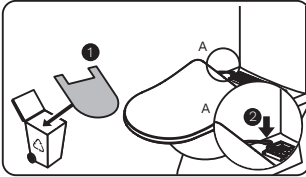

4. Remove the installation template and dispose of it thoughtfully. Insert the inlet hose into the hole in the ceramic

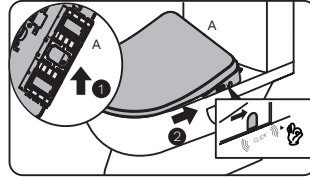

5. Place the seat on the fixing bracket and gently slide it back toward the wall until you hear a 'click'

Connecting the Water

Note: 1. Please use the new hose assembly attached to the product, do not use the old hose assemblies
2. There are two methods of connecting the water.

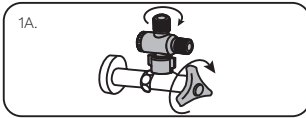

1A.

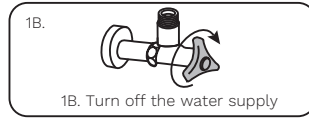

1B.

1B. Turn off the water supply

1A. Close the angle valve and remove the hose connected to the water tank. Connect the three-way adaptor to the angle valve and ensure that the rubber washers are fitted.

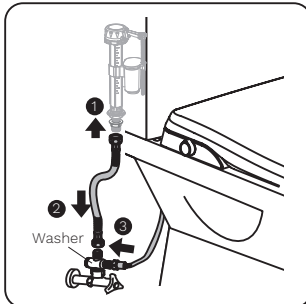

2A. Place the filter and rubber washer on each end of the extension hose, connect the three-way adaptor with the cover plate to the angle valve, then connect the extension hose to the inlet valve and adaptor, and the bidet seat hose to the adaptor

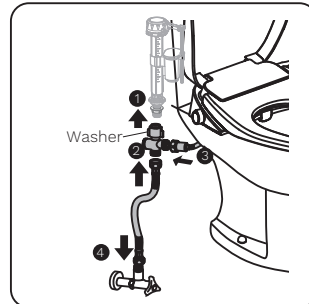

2B. Place the filter and rubber washer on each end of the extension hose, connect the extension hose to the angle valve and then attach the three-way adaptor with the cover plate to the inlet valve and bidet seat hose.

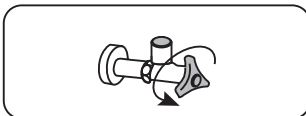

3A & 3B. Open angle valve to check for water leakage.

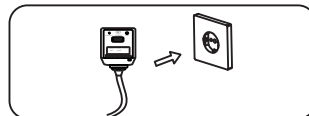

4A & 4B. Plug in and turn on the power supply.



1. Do not disassemble the electronic bidet seat as it may cause mechanical failure, and may void warranty.
2. Do not connect hot water above 40°C or cold water that is susceptible to freezing.

PROCEDURE FOR BOTTOM INLET INSTALLATION

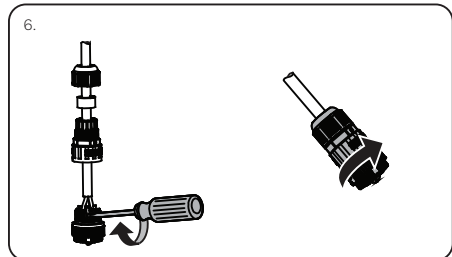
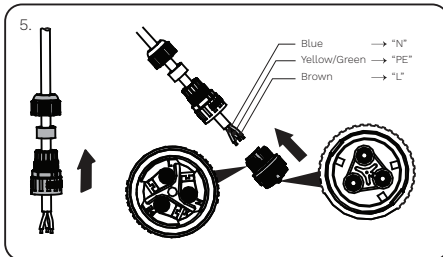
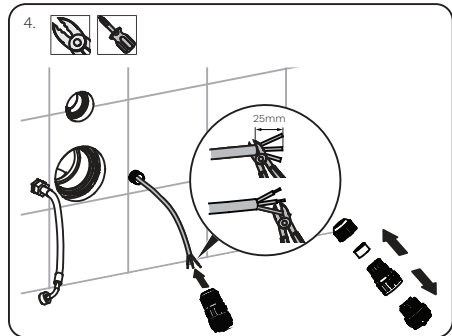
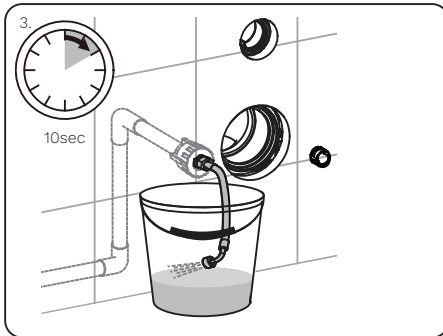
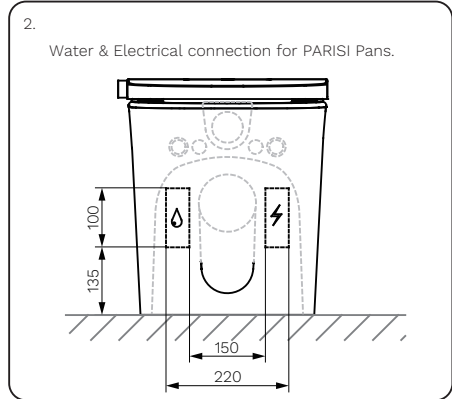
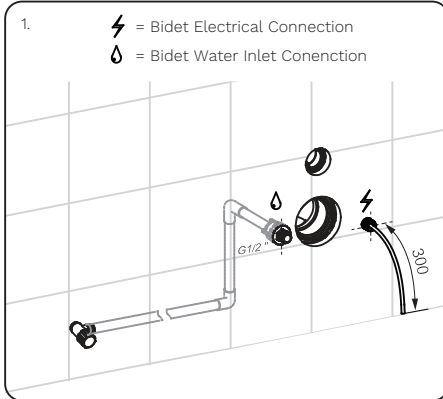

Caution

1. Recommended Water Pressure Range: 150-500kPa.
2. Install mini stop valve close to the product to turn off water during maintenance Fig. 1.
3. Steps 7-12 represent a wall faced pan, follow the method for closed coupled BTW pan.
4. Use the Pan instructions for its installation.



NOTE: CHECK ALL MEASUREMENTS WITH THE PRODUCT ON SITE.

INSTALLATION Cont.

7.

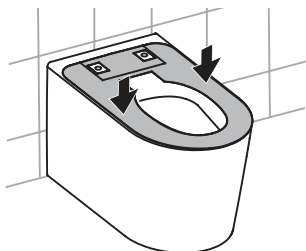

Place the installation template on pan & align carefully with the side & front profile.

8.

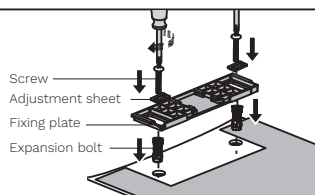

(1) Place the SS adjusting sheet on the fixing plate, align the expansion bolt on hole, and insert into the ceramic hole.

(2) Place the fixing plate on the expansion bolt and tighten the screw with screw driver.

9.



10.

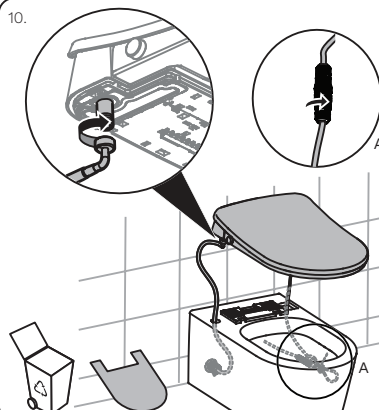

11.

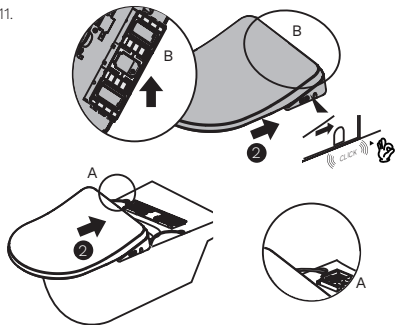

12.

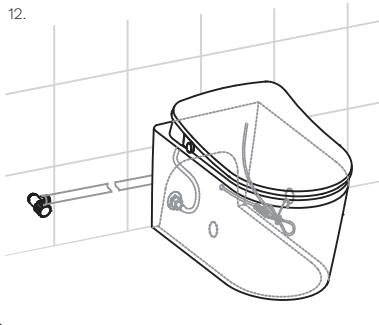

Carefully slide the bidet seat on the fixing plate. The connection is complete when you hear a 'click' sound

OPERATION

Standby Mode

1. Make sure the plug is dry before power supply is connected.
2. After the power supply is connected, the toilet will self-check, and the "beep" indicated that the self-check is completed and the toilet can be used normally. At this time, the control knob lamp and the night light are always on.
3. Water temperature adjustment is enabled, and by default it is set to about 35°C.
4. Seat temperature regulation is enabled, and by default it is set to about 33°C.
5. After the power supply is connected, the control knob light and night light are constantly on. The power usage is about 1 kWh/month without seat heating enabled.

Function of the Control Knob

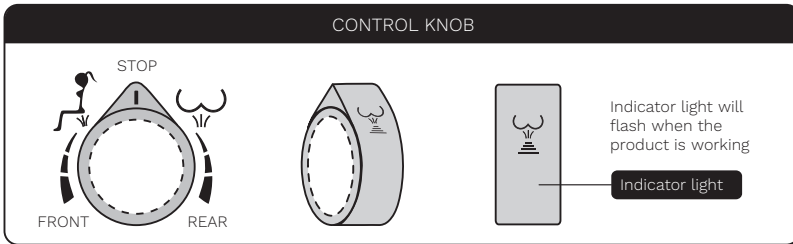

Self-cleaning function

- The nozzle will automatically close after 5 seconds of self-cleaning, when in use
- After the rinse cycle is completed, the nozzle will automatically close after a 2 second self-clean process.

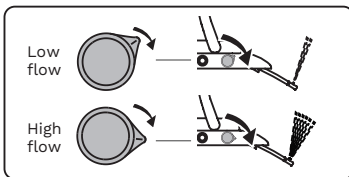

Rear wash function (REAR)

- Turning the control knob clockwise will activate the rear wash function.
- Cold water will discharge from the front end of the nozzle for 5 seconds, then the rear wash nozzle will extend and start to spray water for cleaning.
- The flow varies with the rotation of control knob.

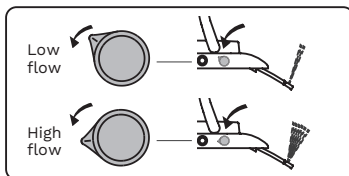

Front wash function (FRONT)

- Turning the control knob anticlockwise will activate the rear wash function.
- Cold water will discharge from the front end of the nozzle for 5 seconds, then the wash nozzle will extend and start to spray water for cleaning.
- The flow varies with the rotation of control knob.

Note: When the Front/Rear wash function is used, please enable the maximum flow. If the washing pressure is too high, adjust the amount of water through the knob, and reduce the washing pressure.

FUNCTION SETTINGS

Function Settings Instruction

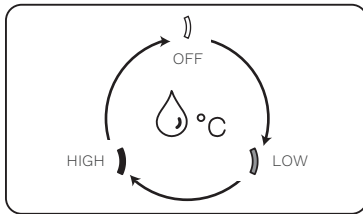
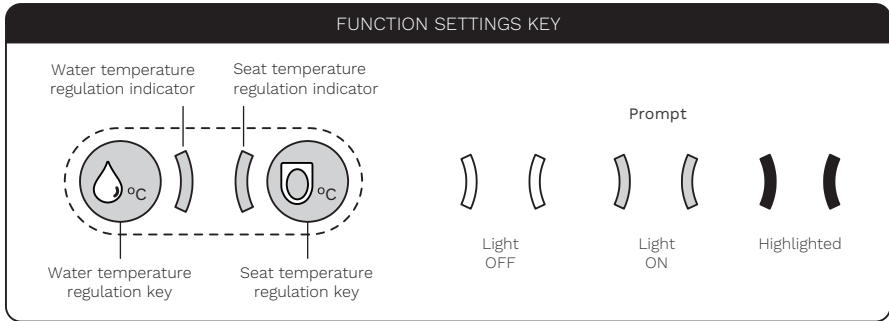

Press "OFF" to toggle between water temperatures as per the sequence indicated in the image on the left.

- When you turn off the water temperature control you will hear a two second "beep". When you switch between temperatures you will hear a one second "beep".
- Water temperature low gear: about 35°C
Water temperature high gear: about 38°C

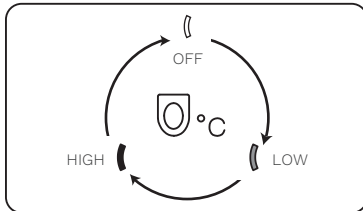

- Press "OFF" to toggle between seat temperatures as per the sequence indicated in the image on the left.
- When you turn off the seat temperature control you will hear a two second "beep". When you switch between temperatures you will hear a one second "beep".
- Seat temperature low gear: about 33°C
Seat temperature high gear: about 37°C

Protection Functions

1. Low temperature scalding protection function: 5 min after you are seated, the seat will switch to low temperature scalding protection mode with temperature of about 29°C.
2. Alarm function: If you stand up after using the seat and don't turn off the controls, an alarm will sound.
3. Water temperature protection function
 - (1) When the water temperature exceeds 43°C during use, the water will be turned off, and the seat will automatically switch to self-cleaning mode.
 - (2) After the water temperature returns to normal, operation can be continued.

Note: After the rinse is over, turn the control knob to the neutral stop position to prevent splashing.

Normal Use During Power Failure

The water temperature and seat temperature cannot be adjusted when the power supply for product is cut off, but flushing with normal temperature can be used.

CLEANING AND MAINTENANCE

Manual Cleaning of Spray Tube

- Gently pull out the nozzle and clean it with warm water and a soft cloth or small brush.
- DO NOT APPLY EXCESSIVE PRESSURE!

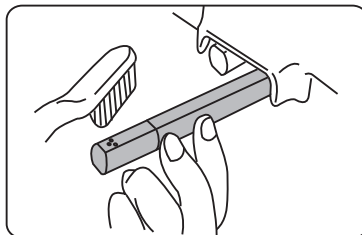

Clean Filter Screen

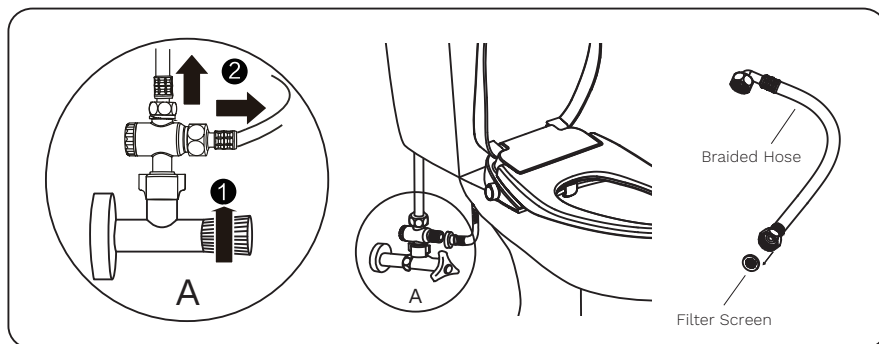

TIPS:

- Make sure that the angle valve is closed and the power is off before you clean the filter screen;
- Clean the filter screen when you noticed a reduction in water flow.
- During the cleaning process, the filter screen must be removed from the water inlet hose;
- Reinstall the filter screen in reverse order after cleaning.

Product Surface Cleaning



Note: Please turn off power supply before cleaning

- Wipe the product surface with a soft cloth, warm water and a neutral detergent.
- Lift the upper cover and the seat ring when cleaning the ceramic
- Do not put close the seat and lid before the cleaning agent on the ceramic toilet is completely washed and dried, otherwise the seat surface may get damaged by the evaporation of cleaning agent.

CLEANING AND MAINTENANCE Cont.

Surge Protector

Check the surge protector regularly, at least once a month.

Inspection Method:

- Press the "Reset" button and the indicator light will illuminate and the power will turn on.
- Press the "Test" button and the indicator light and power will turn off.
- When the operation has completed, if an error has been detected, stop using the seat and refer to the trouble shooting guide on page 13 for further information.
- Please ensure that the surge protector indicator light is always on when the product is operating.

Schematic diagram of surge protector:

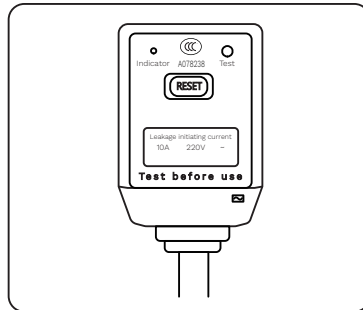

Product Maintenance in Winter

If the water temperature drops below 0°C, frozen water can damage the system. Stop using the seat and shut off the angle valve when the ambient temperature is below 0°C.

Intended Prolongued Inactivity

If this seat will not be used for an extended period of time, drain the water in the seat and turn off the power supply:

- Disconnect the power cable from the socket or press the "Test" key on surge protector.
- Turn off the water supply to the bidet seat
- Remove water inlet hose from the angle valve to the toilet end, and empty the water in the water inlet hose.
- Close the upper cover, press and hold the removal button and slide the seat cover forward to release the seat from the bracket. Lift to remove the seat.
- Place the cover in a cool and dry place.

TROUBLESHOOTING

Basic Diagnosis

If your smart seat is not operating properly.	
Check power supply: 1. Is the power supply on 2. Has the surge protector tripped	Check water supply: 1. Is the water at the mains on 2. Is the angle valve on
If the following occurs, turn off the power supply immediately.	
The buzzer continues to beep	The surge protector trips frequently



Note: When water leakage occurs, close the angle valve and turn off the power supply.

Water Leakage Analysis

Issue	Possible Cause	Solution
Water leaking under the seat	Pressure maintaining valve is damaged	Turn off the power supply, close the angle valve, have your plumber check the water pressure is below 0.5Mpa. Contact the after sales department.
Flushing module running	Knob is not set to OFF position	Reset control knob to OFF
	Control valve is broken	Turn off the power supply, close the angle valve and contact the after sales department.

Seat Not Heating

Issue	Possible Cause	Solution
Seat temperature is too cold	Seat temperature is set to low	Adjust seat temperature to a higher level, see page 10.
Seat temperature is too hot	Seat temperature is set to high	Adjust seat temperature to a lower level, see page 10.
Set temperature is too cold when you have just seated.	Disabled seat heating function	Enable seat heating function in advance, see page 10.
No seat heating function	Seat heating coil is broken	Turn off the power supply and contact the after sales department.

Washing Analysis

Issue	Possible Cause	Solution
Spray tube extends too slowly	Cool water should be released from front end before flushing	This is normal, and will start a wash in about 5 seconds.
Insufficient water amount	Knob is not completely turned on	Turn the knob for more water.
Insufficient water temperature	Water temperature is set to low	Adjust water temperature to a higher level, see page 10.
Water temperature is cold	Water temperature is set to the lowest level	Adjust water temperature to a higher level, see page 10.
	Automatic protection for when the seat has overheated.	It will automatically restart when the water temperature has been reduced.
Water flows out when seated	Self-cleaning function is enabled	This is normal, and will automatically stops after 5 seconds.
Water is not heated. Indicator light not flashing	The flow meter is broken	Turn off the power supply, and contact the after sales department.

Night Light Analysis

Issue	Possible Cause
Night light is not ON	Power cord of night light is damaged
	Night light is damaged
Knob light is not ON	Power cord of control knob light is damaged

Alarm Function

Issue	Possible Cause	Solution
Buzzer continuously beeps	Control knob is not in the off position when you have stood up from the seat	Reset control knob to the OFF position.

Technical drawing of the EC105 - BOTTOM INLET toilet seat, showing side and top views with dimensions in mm.

Side View Dimensions:

- Overall width: 95
- Bottom flange width: 36
- Bottom flange thickness: 4.5

Top View Dimensions:

- Overall width: 393
- Overall height: 512
- Seat opening width: 211
- Seat opening height: 303
- Distance from seat opening to top edge: 468
- Distance from seat opening to bottom edge: 63
- Distance between mounting holes: 136-174
- Overall width at mounting holes: 375

Unit: mm

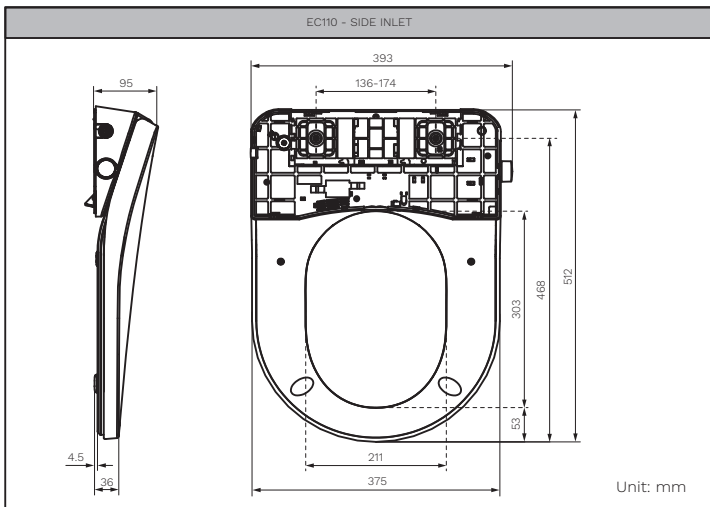

TECHNICAL DATA

Items	Description
Rated Voltage	220-240V~, 50/60Hz
Rated Power Consumption	960W (Under the conditions: entering water temperature 15°C, flow rate 6000ml/min)
Maximum Power Consumption	1550W/220V
Length Of Power Cord	1.5m
Water Supply Pressure	0.1-0.5MPa
Water Supply Temperature	4~35°C
Ambient Temperature	4~40°C
Protection Class	IPX4
Water Volume	≤0.7L/min (at a water pressure of 0.18MPa), Stepless regulation
Water Temperature	3 Settings (Normal temp./35°C/38°C)
Water Heater Power Consumption	1500W/220V
Seat Temperature	3 Settings (Room temp./33°C/37°C)
Seat Heater Power Consumption	50W/220V
Nozzle And Seat	Antibacterial Material
Slow Closing Seat/Lid	Yes

Contact Details: www.parisi.com.au/contact

PARISI

Electric Bidet Seats

Model No.: EC105, EC110

Voltage: 220-240V~,50/60Hz

Rated Power: 960W

Water Pressure: 0.1-0.5MPa

Protection Class: IPX4



WARNING:
THIS DOUCHE SEAT MUST BE INSTALLED WITH APPROPRIATE BACKFLOW PROTECTION CONFORMING TO THE NATIONAL CONSTRUCTION CODE VOLUME 3.
INSTALLATION MUST BEIN ACCORDANCE WITH AS/NZS 3500.2 AND PLUMBING CODE OF AUSTRALIA.

