

**TECElux Mini flush plate with electronic touchless actuation****Article number:** 9240960**Colour:** Polished white glass**Exhibition samples:** Yes**DU 1:** 1 pc.**Description:**

Electronic flush plate with touch-free actuation for TECE cisterns with front actuation and actuation height of approx. 1 m (centre flush plate). Flat glass actuation including mounting materials and actuation motor for dual-flush. Suitable for flush-mounted installation. Compatible with insert chute for cleaning tablets.

Dimensions (W x H x D): 220 x 150 x 8 mm

Function of the electronics:

The sensor detects when a person is approaching the toilet, and only illuminates the flush buttons then. The flush actuation is touch-free or by touching the button area. By programming with the TECElux Mini programming remote control (Item No. 9240971), the electronics can be adjusted to individual requirements.

Programmable functions (with programming remote control):

- Sensor recognition field
- Hygiene flush
- Actuation time
- Safety flush
- Display illumination brightness

Please order separately:

- TECE transformer for toilet electronics incl. connection cable (Item No. 9810012)
- Toilet installation frame for flush-mounted installation
- Programmable remote control (Item No. 9240971)

Note:

- TECElux Mini requires a power connection.
- Not compatible with toilet modules of installation heights 980, 820 and 750 mm.
- Not compatible with the TOTO Washlet RX and SX.

Sales data:

Product name: TECElux Mini, polished white glass

Commodity group: 904

Product group: 2009040250

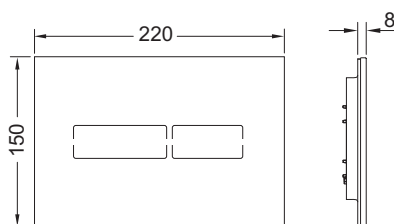

Spare parts:

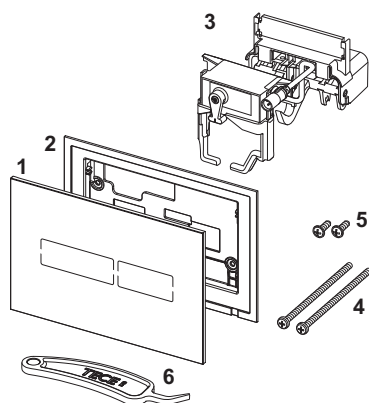

- | | | |
|---|---------|--|
| 1 | 9820369 | Cover plate polished white glass |
| 2 | 9820397 | Support frame |
| 3 | 9820493 | Actuation motor for TECE cistern |
| 4 | 9820497 | "easy fit" attachment screws (from 2021) |
| 5 | 9820263 | Fastening screws (2003-2020) |
| 6 | 9820390 | Dismounting and programming key |